



HO Structure Kit CHAMPION PACKING PLANT

933-3048

Thanks for purchasing this Cornerstone Series® kit. Please read all instructions and study the drawings before starting. All parts are styrene plastic, so use compatible glue. If you wish to decorate your model, use paints for plastic models. With appropriate details and signs, your finished model fits almost any era.

The Champion Packing Co. building is based on a plant in Waterloo, IA and has been carefully designed to fit most layouts. Production at these plants was constant, generating considerable traffic and operating possibilities.

All important part of your new industry can be modeled with the Stockyard (933-3047). This includes two pens with gates and a shed to provide shelter. These modular kits can be combined to build larger facilities. For the finishing detail, our Beef Cattle set (933-3143) provides live cattle for the Stockyards.

See your local hobby dealer, Walthers Latest HO Scale Reference book or visit our Web site at www.waltherscornerstone.com for additional accessories to complete your new scene.

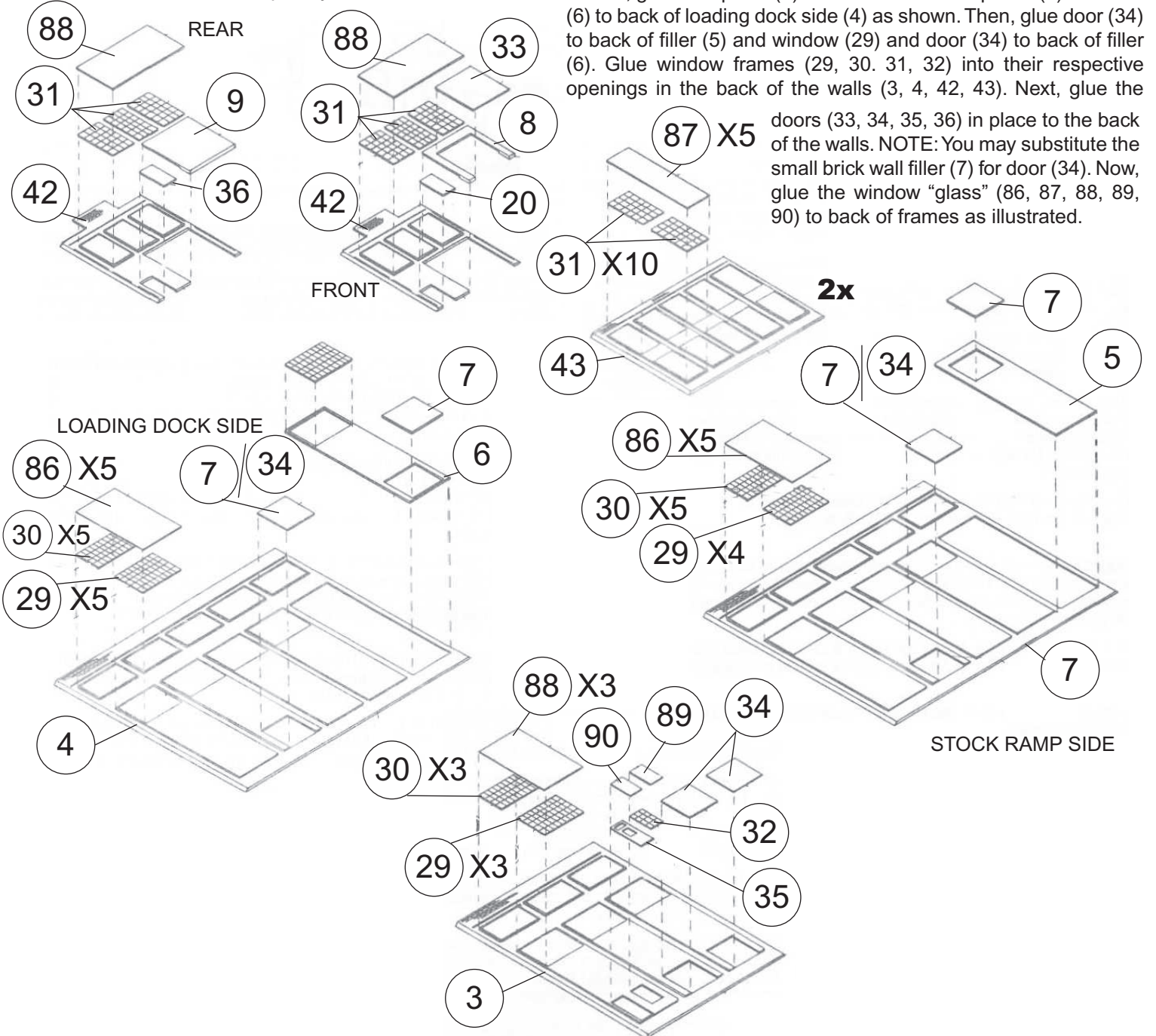

2. First, bend floors (62, 63, 64) and roofs (73, 74,75) slightly at grooves to match the sides (66, 67, 71,72). Now, glue sides to the floor, starting at the upper end of the ramp. Next, glue side/floor assembly to roofs. Glue supports (76, 77,78,79,80) to floor and before glue hardens, set the assembly upright and make sure the supports are vertical. NOTE: The upper end of the ramp will go into the upper level doorway on the stock ramp side of the building ("A" to "A" in illustrations).

One Piece Smokestack

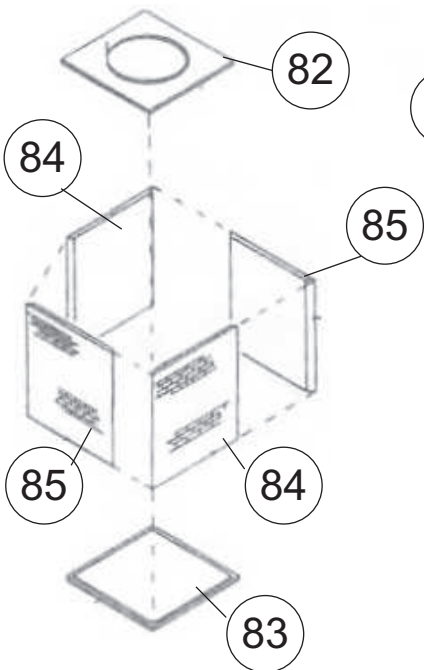
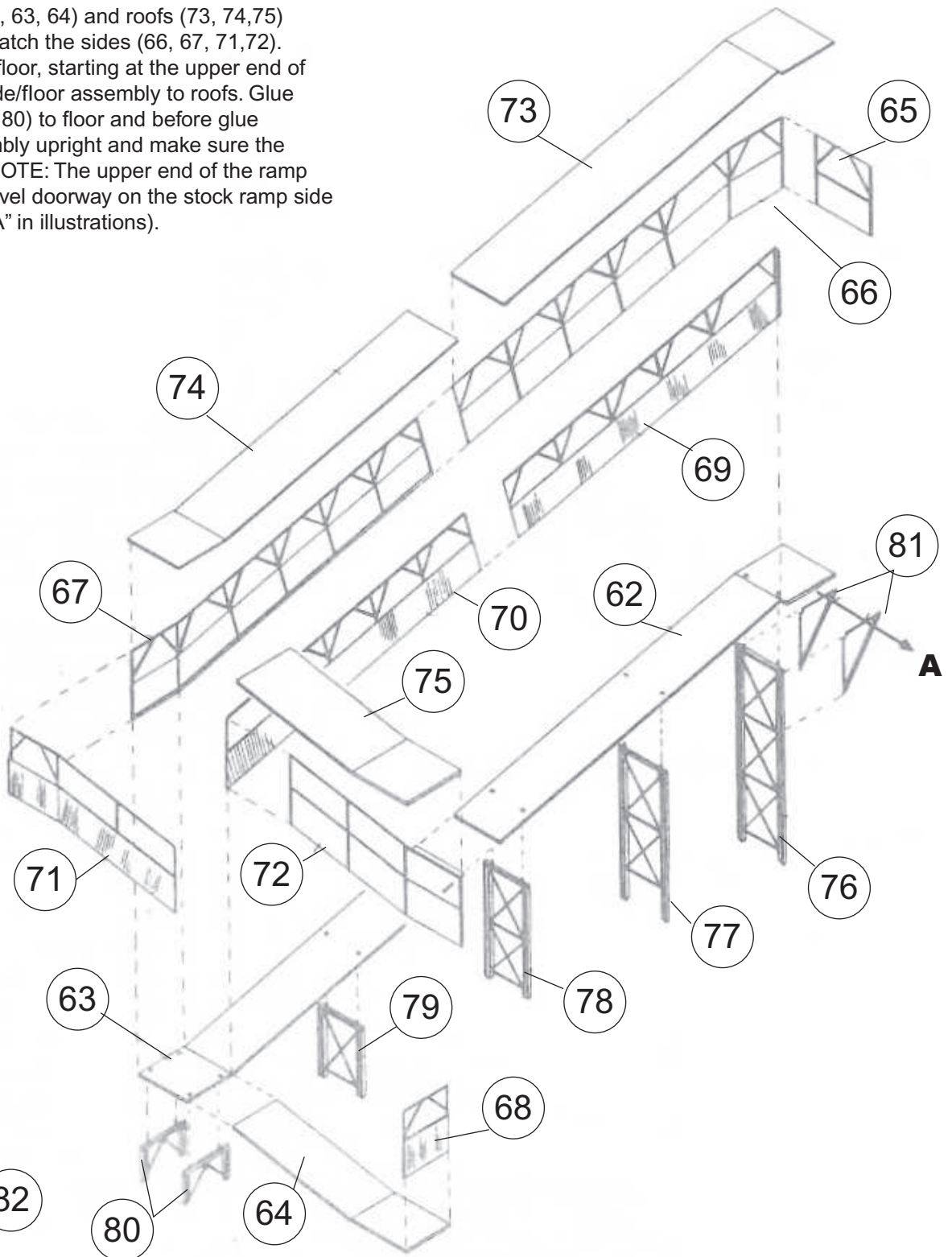
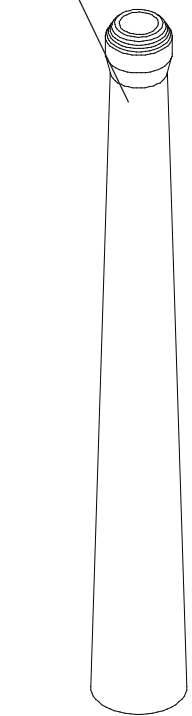

3. Glue sides (84, 85) together and to base (83) and then glue top (82) to sides. Glue smoke stack to (82).

4. Glue the boiler house walls (42, 43) together and to the base (45). Next, glue the cooling tower sides (46, 47) together and to the roof (44). Then, glue top (48) to sides and railings (49, 50, 51) into the holes in edge of top. Glue ladder (52) to end of cooling tower that has short railing (51).

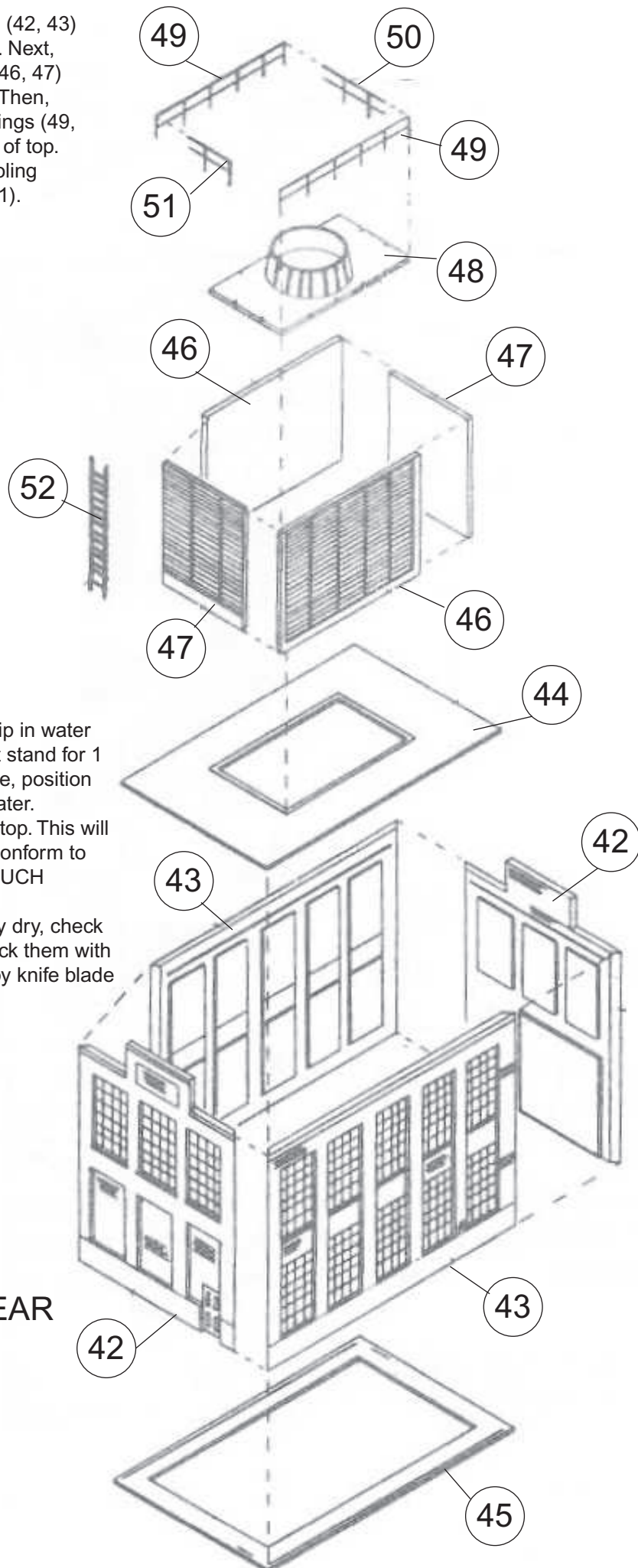

DECALING

1. After cutting out the decal, dip in water for 10 seconds, remove and let stand for 1 minute. Slide decal onto surface, position and then blot off any excess water.
2. Lightly brush Micro Sol® on top. This will soften the decal allowing it to conform to irregular surfaces. **DO NOT TOUCH DECAL while wet!**
3. When the decal is thoroughly dry, check for any trapped air bubbles. Prick them with the point of a small pin or hobby knife blade and apply more Micro Sol®.

5. Glue walls (3, 4) together and to base (1). Then, glue roof (10) in place. Glue ventilator caps (16) to roof. Assemble stairwell shed sides (11, 12) to door (13) and then glue the roof pieces (24, 15) to the sides. Next, glue completed shed to the roof at locating ridges.

6. Glue water tower sides (17) together and to platform (19), and then glue on top (18). Next, glue the supports (21) together at their beveled edges. Then, glue the cap pieces (22) over corner joints to form H-columns. Glue support assembly into the notches in bottom of platform. Glue pipe halves (20) together and into hole in platform. Before glue dries, place the assembled tower on a flat surface to make sure pipe is flush and perpendicular to said surface. Now, glue assembled water tower on roof where desired.

7. Glue step platform sides (38, 39) to platform (37). Glue steps (40) to (37) and (38). Then, glue railing (41) into holes in (37). Glue these assemblies to base (1) and wall (3) at locations "C".

8. First, glue platform supports (24) into base (2). Then, glue platform (23) to the tops of the supports. Small pegs on bottom of platform go to the inside of the supports. Glue platform base (2) to building base (1). Glue end bracket (26) to base and then glue roof brackets (25) into holes in wall (4). Glue platform roof (28) to the brackets. Then, glue meat rails (27) to vertical hangers on (25) & (26). Protruding nubs on hangers go above the rails. You may now glue hanging beef (93) to the rails.

2x - Place at B locations

