



# HO Scale Structure Kit

## HOBBY SHOP

933-3475

Thanks for purchasing this Cornerstone Series® kit. Please read all instructions and study the drawings before starting; directions for the interior graphics are printed directly on that sheet. All parts are styrene plastic, so use compatible glue. If you wish to decorate your model, use paints for plastic models. With appropriate details and signs, your finished model fits almost any era.

For centuries humans have had to work pretty hard just to survive. But along the way, we developed a lot of new skills and abilities, including creativity and patience, as we learned to work with our hands. Finding a safe way to pass on some of these skills to the next generation eventually led to the creation of toys, and in turn, the ideas of arts and crafts. But it wasn't until the early years of the 20th century when the change from an agricultural to an industrial society offered adults a few hours of leisure time, and a little extra money. When funds became scarce in the 1930s, many adults and older children took up hobbies to occupy their time. Some turned their own hobbies into small business ventures, and others set up small businesses to sell their products, creating the first hobby shops. Many also added sidelines under the same roof, such as hardware stores (that attracted a largely male audience) or sold and serviced bicycles as well as traditional toys. Today the hobby shop still holds a place of honor in many shopping districts, serving generations of families and helping develop new skills and interests.

1. Glue Window Glass (12, 10) to Door Frames (11, 9). Glue Block Window Glass (13) to Back Wall. Glue Door Assemblies (11, 9) to Back Wall.
2. Glue Windows #16 and #21 to the clear part #27 using the locating pins and holes.
3. Cut Door (#18) from the sprue being careful to save the small part locating tabs on the top and sides. Glue the Door (#18) to the center of the Clear part (#27). Glue the Door Handles (#19) into the slots in the door.

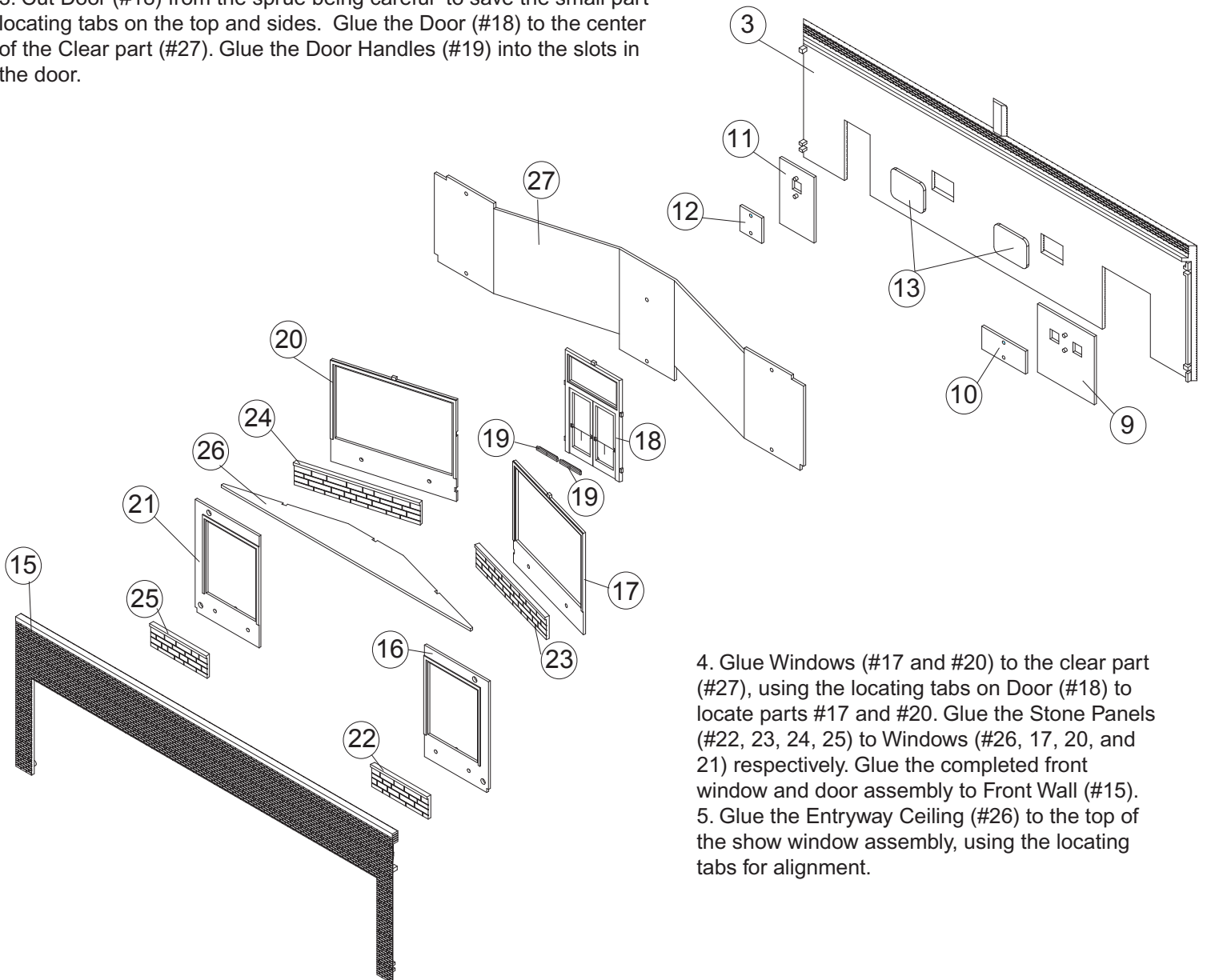

4. Glue Windows (#17 and #20) to the clear part (#27), using the locating tabs on Door (#18) to locate parts #17 and #20. Glue the Stone Panels (#22, 23, 24, 25) to Windows (#26, 17, 20, and 21) respectively. Glue the completed front window and door assembly to Front Wall (#15).
5. Glue the Entryway Ceiling (#26) to the top of the show window assembly, using the locating tabs for alignment.

6. Glue the four Wall Assemblies (15, 2, 3, 4) to the Roof (14).
7. Glue three Chimney Sides (5, 6, 7) together. Then glue Chimney Assembly to Back Wall (3) to complete the Chimney.
8. Glue the Chimney Cap (8) to top of Chimney Assembly.
9. The finished structure can be set on the Base (1) if you wish to add interior details at a later time or, glued in place to complete construction.

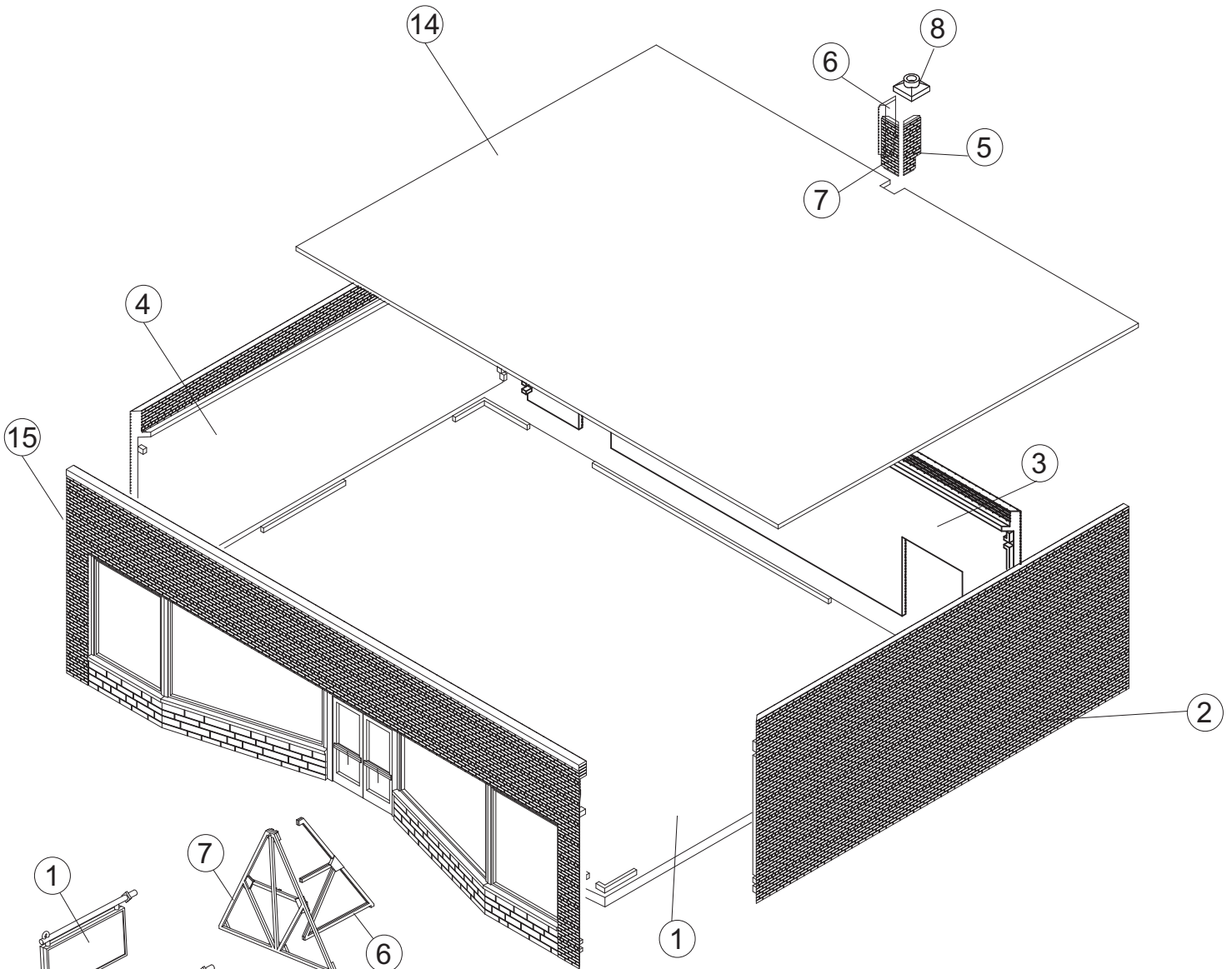

10. For a sign, you can choose #1 or #5 from the sign sprue. Using a #56 drill bit, drill a hole in the middle of wall #15 about 1/4 inch (0.6cm) down from the top edge. Glue the sign into the hole. Assemble the sign brace from parts #6 and #7 and glue this to the roof above the sign location and up against the inside of the wall. Use fine brass wire (not included) to make the support rod from the top of the sign brace to the sign.

### SIGNS

To mount the signs, simply cut desired sign from sheet. Apply a small drop of white glue on the back and place on sign (#1 or #5)